

Plain City Corporation  
4160 W 2200 N  
Plain City, UT 84404  
Telephone (801) 731-4908 Fax (801) 731-8619

## How To Draw A Simple Site Plan

**Step 1:** Draw the basic shape of your property (the lot your house is on):

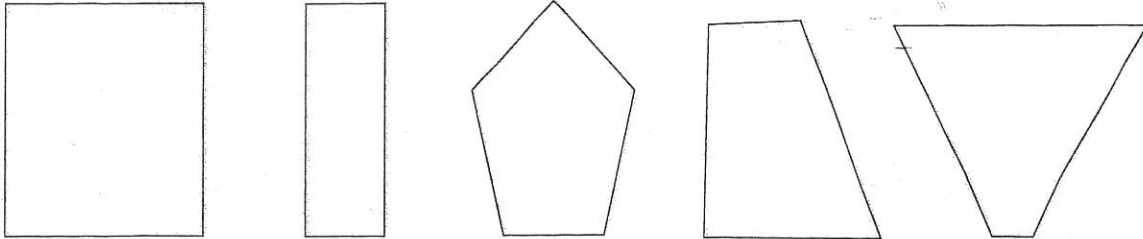

**Step 2:** Draw all the permanent structures.....

**Step 3:**

After you have drawn all the "hard features" on your property, such as buildings, driveways, patios, walls, etc, take a measurement from the main structure to the property line in all four directions. Write the measurements on the site plan.

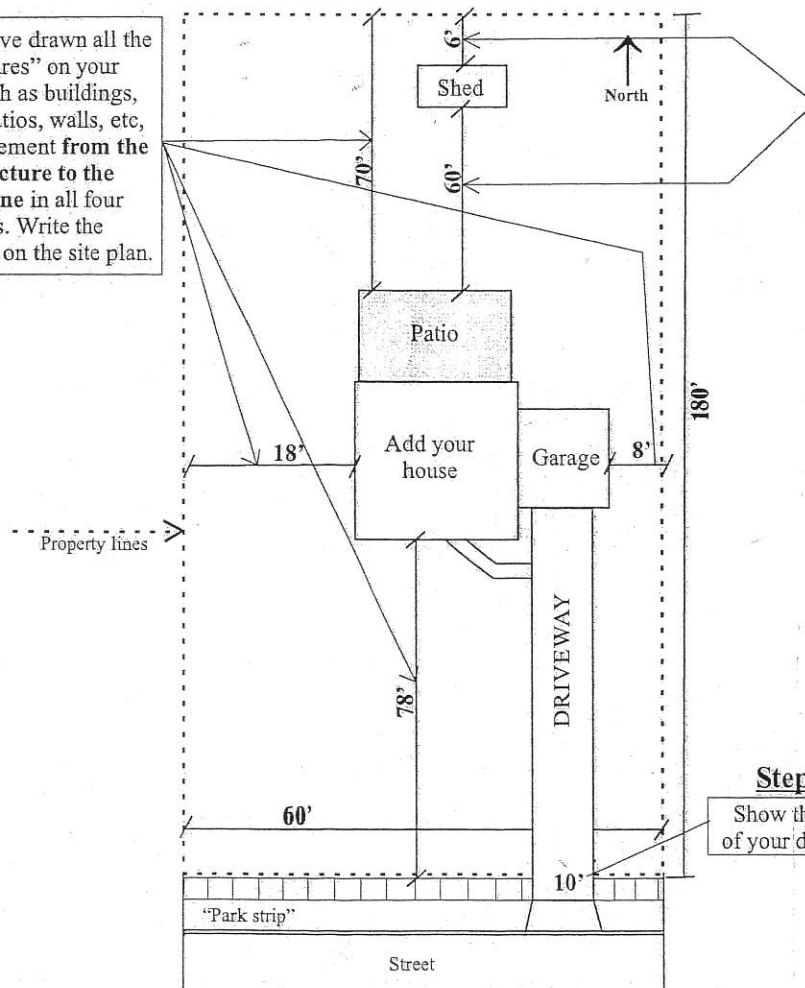

**Step 4:**

Take measurements from the main structure to any outbuildings, and from those outbuildings to the property line. Write these on the site plan.

**Step 5:**

Show the width of your driveway

**Note\*** This is a sample of an imaginary property. You cannot use it for *your* property. Use it only as a *guide* to draw your own. Your drawing does not need to be done on a computer...it can be drawn with pencil and paper.